

SHRINK DIP SOCKETS

Adapters-Plus Shrink DIP sockets are available in standard and custom configurations. The following are some of the Screw Machine header pins available. Please let us know if the pin you are searching for is not listed.

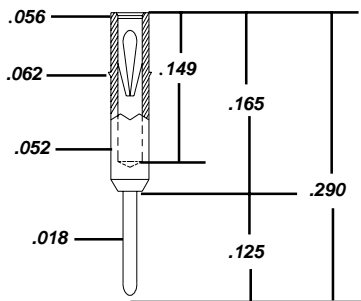

Pin numbers:
 285B: Plating G/G Mating Min/Max: .015/.026
 282B: Plating G/T Mating Min/Max: .015/.026

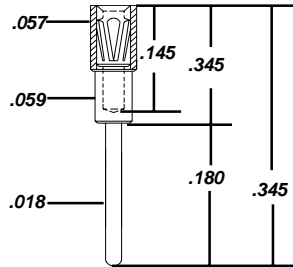

Pin Number:
 055B: Plating G/T Mating Min/Max: .015/.026
 091B: Plating G/G Mating Min/Max: .015/.026

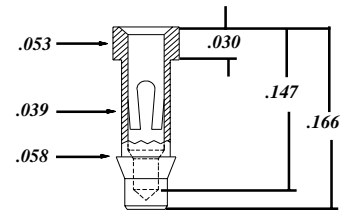

Pin Numbers:
 619C: Plating G/T Mating Min/Max: .015/022
 623: Plating T/T Mating Min/Max: .015/026

Specifications:

Standard material: Glass Epoxy FR-4, IPC-4101/24, MIL-S-13949/04-GF/GFGUL: 94V-0, Continuous use temp 150c, Heat deflection Temp (@264 psi) 175c

High Temp material: Glass reinforced Polyimide, IPC-4101/42, MIL-S-13949/10-GI/GIJ UL: 94V-0, Continuous use temp 250c, Heat deflection Temp (@264 psi) 270c

Ordering Information:

