

PLCC OPEN TOP

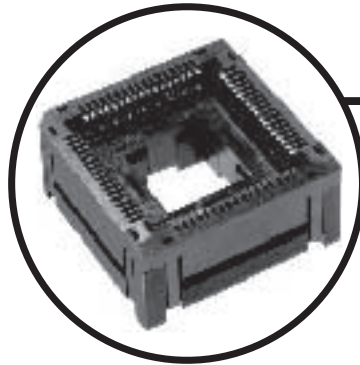

IC120 Series

Insulation Resistance: 1,000M $\frac{1}{2}$ minimum at 500 VDC
Withstanding Voltage: 700 VAC for 1 minute
Contact Resistance: 30m $\frac{1}{2}$ max. at 10mA/20vA (Initial)
Operating Temperature: -40 C ~ +170 C

Insulator: PPS/PEI (Glass Filled)
Contact: Beryllium m Copper
Plating: Gold over Nickel

Characteristics

Material

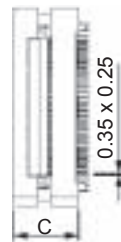
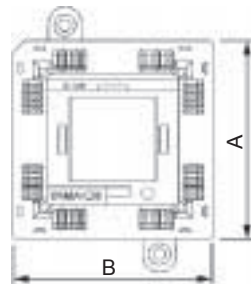
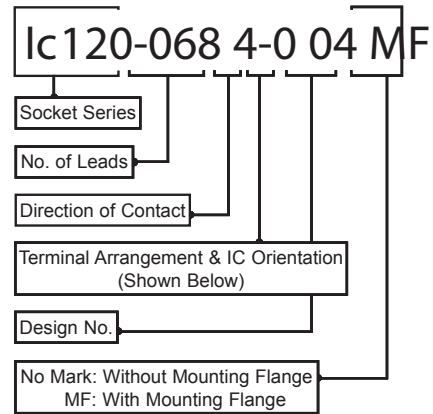

Dead-bug type (DB)

Live-bug type (LB)

Part Number	No. of Leads	In. Dir. IC	Socket Dim.		
			A	B	C
IC120-0184-002	18	DB	17.0	21.5	18.0
IC120-0184-102	18	LB	17.0	21.5	19.3
IC120-0184-202	18	DB	17.0	21.5	18.0
IC120-0184-302	18	LB	17.0	21.5	19.3
IC120-0204-005	20	DB	20.0	20.0	18.0
IC120-0204-205	20	DB	20.0	20.0	18.0
IC120-0204-405	20	DB	20.0	20.0	18.0
IC120-0224-001	22	DB	17.0	21.5	18.0
IC120-0224-101	22	LB	17.0	21.5	19.3
IC120-0224-301	22	LB	17.0	21.5	19.3
IC120-0284-008	28	DB	23.0	23.0	19.3
IC120-0284-108	28	LB	23.0	23.0	18.0
IC120-0284-208	28	DB	23.0	23.0	19.3
IC120-0284-308	28	LB	23.0	23.0	18.0
IC120-0284-408	28	DB	23.0	23.0	19.3
IC120-0284-508	28	LB	23.0	23.0	18.0
IC120-0324-009	32	DB	22.5	25.0	19.3
IC120-0324-109	32	LB	22.5	25.0	18.0
IC120-0324-209	32	DB	22.5	25.0	19.3
IC120-0324-309	32	LB	22.5	25.0	18.0
IC120-0324-409	32	DB	22.5	25.0	19.3
IC120-0324-509	32	LB	22.5	25.0	18.0
IC120-0444-006	44	DB	28.0	28.0	19.3

Most Compatible

Part Number	No. of Leads	In. Dir. IC	Socket Dim.		
			A	B	C
IC120-0444-106	44	LB	28.0	28.0	19.3
IC120-0444-206	44	DB	28.0	28.0	18.0
IC120-0444-306	44	LB	28.0	28.0	19.3
IC120-0444-406	44	DB	28.0	28.0	18.0
IC120-0444-506	44	LB	28.0	28.0	19.3
IC120-0524-007	52	DB	30.0	30.0	18.0
IC120-0524-107	52	LB	30.0	30.0	19.3
IC120-0524-207	52	DB	30.0	30.0	18.0
IC120-0524-307	52	LB	30.0	30.0	19.3
IC120-0524-407	52	DB	30.0	30.0	18.0
IC120-0524-507	52	LB	30.0	30.0	19.3
IC120-0684-004	68	DB	35.0	35.0	18.0
IC120-0684-104	68	LB	35.0	35.0	19.3
IC120-0684-204	68	DB	35.0	35.0	18.0
IC120-0684-304	68	LB	35.0	35.0	19.3
IC120-0684-404	68	DB	35.0	35.0	18.0
IC120-0684-504	68	LB	35.0	35.0	19.3
IC120-0844-003	84	DB	40.0	40.0	18.0
IC120-0844-103	84	LB	40.0	40.0	19.3
IC120-0844-203	84	DB	40.0	40.0	18.0
IC120-0844-303	84	LB	40.0	40.0	19.3
IC120-0844-403	84	DB	40.0	40.0	18.0
IC120-0844-503	84	LB	40.0	40.0	19.3

Most Compatible

PLCC OPEN TOP

PC BOARD LAYOUTS

IC120 Series

**IC120-0184-002
IC120-0184-102**

(18 Pins)

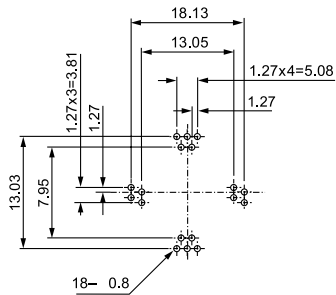

**IC120-0184-202
IC120-0184-302**

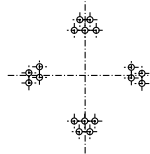

IC120-0204-005

(20 Pins)

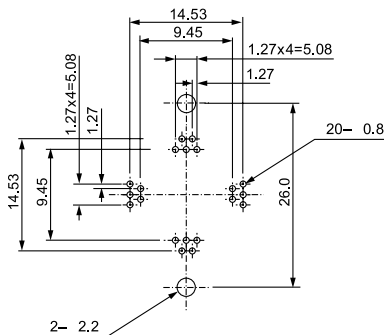

IC120-0204-205

IC120-0204-405

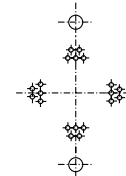
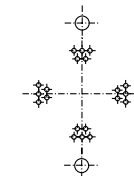

Most compatible
socket type

**IC120-0224-001
IC120-0224-101**

(22 Pins)

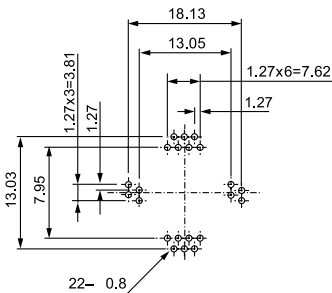

**IC120-0224-201
IC120-0224-301**

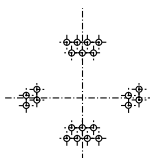

PLCC OPEN TOP

PC BOARD LAYOUTS

IC120-0284-008
IC120-0284-108

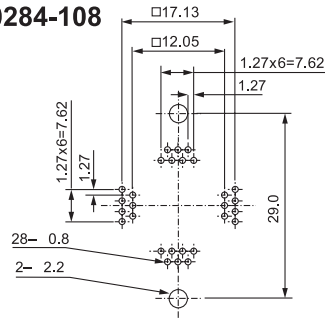

(28 Pins)

IC120-0284-208
IC120-0284-308

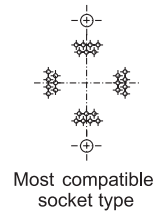

IC120-0284-408
IC120-0284-508

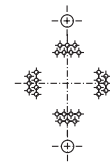

IC120-0324-009
IC120-0324-109

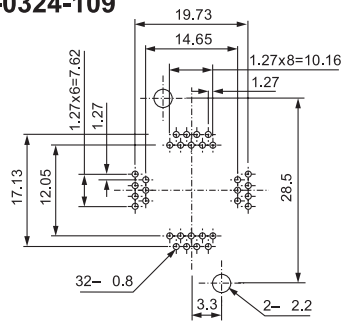

(32 Pins)

IC120-0324-209
IC120-0324-309

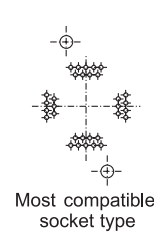

IC120-0324-409
IC120-0324-509

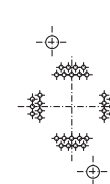

IC120-0444-006
IC120-0444-106

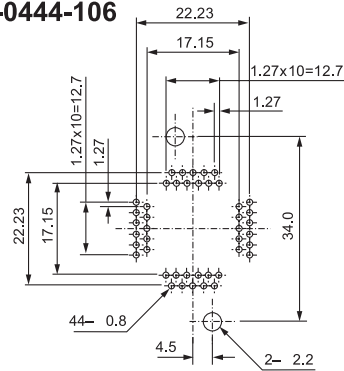

(44 Pins)

IC120-0444-206
IC120-0444-306

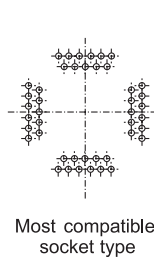

IC120-0444-406
IC120-0444-506

